

TOTAL BUILDING **INSULATION** WITH



WINLUCK[®]

EXTRUDED POLYSTYRENE BOARD



PRODUCT DESCRIPTION

WINLUCK is an extruded polystyrene foam board commonly known as XPS. It has a closed cell structure with skins on both sides. This foam board is specially formulated and produced by a continuous, fully automated extrusion process and in accordance with international standards and specifications. WINLUCK is highly resistance to water absorption, dimensional stability, uniform density distribution, high compressive strength, aging resistance and also immunity against insects, bacteria, pest and rodent attacks as it does not provide them with nutrients. WINLUCK is classified as a fire retardard material and is tested according to UL Underwriters Laboratories Inc, USA.

COLOUR

WINLUCK is supplied to its standard blue colour. Other colours can be produced upon request.

THICKNESS

The standard thickness comes in 25mm, 30mm, 40mm and 50mm. Other thickness ranging from 10mm to 60mm can also be produced upon request.

SIZE

The standard sizes available are 1818mm x 909mm and 1200mm x 600mm

TYPE OF JOINT

Available in standard butt joints and shiplap joints.



WALL INSULATION

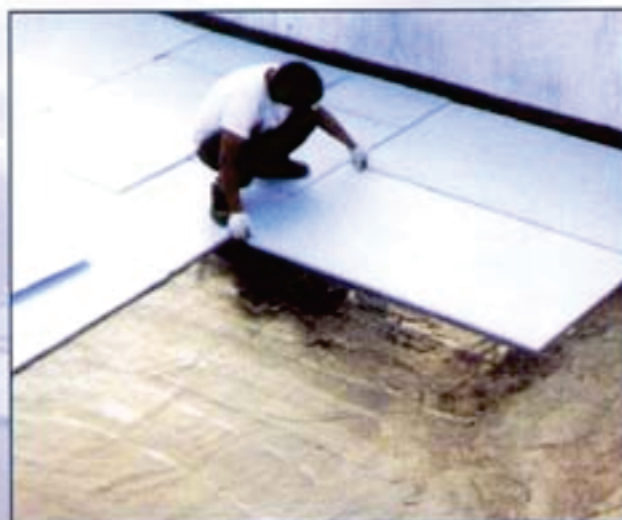

INSULATION TO CONCRETE ROOF

APPLICATIONS OF WINLUCK BOARD

CAVITY WALL INSULATION

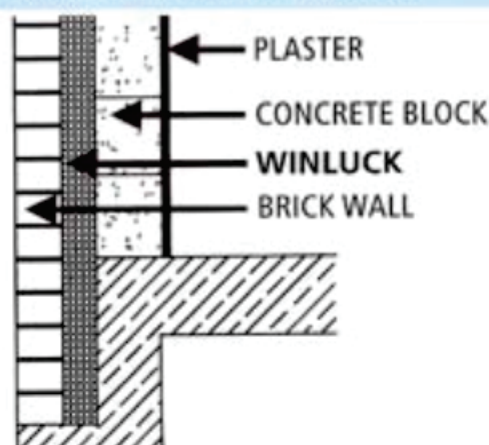

INTERNAL WALL INSULATION

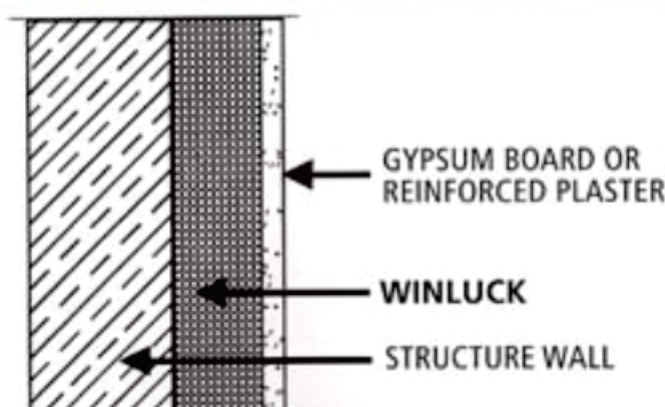



RAISED FLOOR SYSTEM

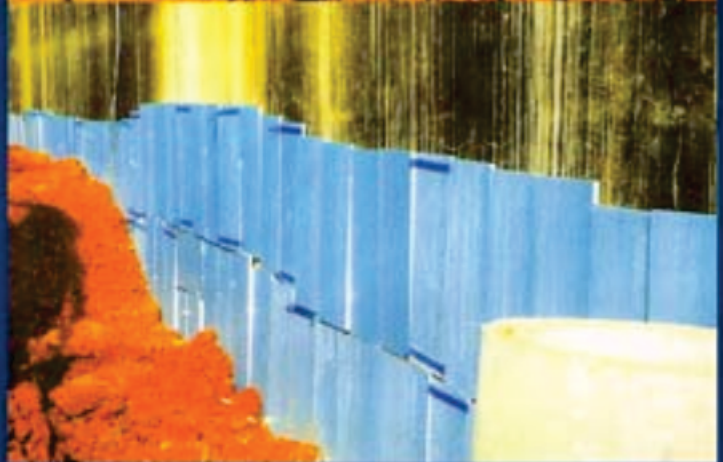

**PROTECTION TO BASEMENT
WATERPROOFING**

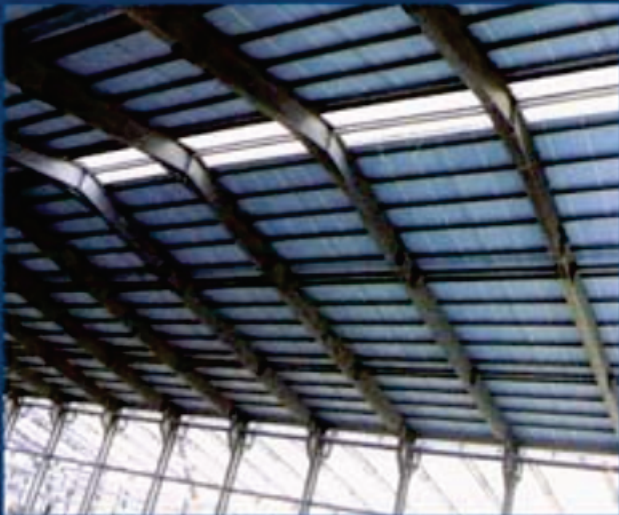

INSULATION TO METAL ROOF

WINLUCK®

INVERTED ROOF SYSTEM TO RC ROOF

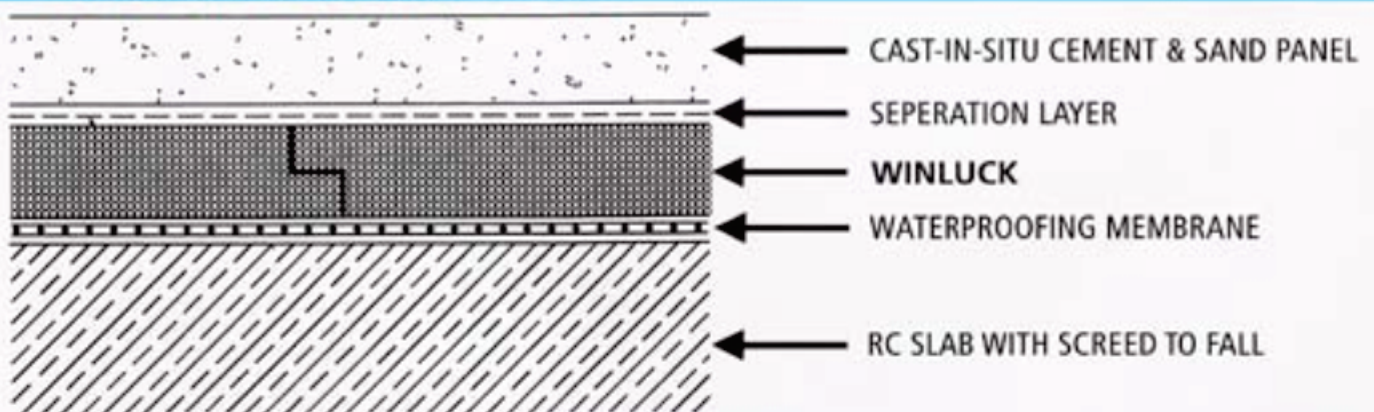

TECHNICAL SPECIFICATIONS OF WINLUCK BOARD

Properties	Unit	Average Value	Test Methods	Tested By
Density	kg/m ³	40 to 50	ASTM D1622	PSB SINGAPORE
Water Absorption	% in Vol	0.10 to 0.40	ASTM C272	PSB SINGAPORE
Compressive Strength at 10%	N/mm ²	0.4	ASTM D1621	PSB SINGAPORE
Thermal Conductivity	KCal/mhK	0.0262	ASTM C518	PSB SINGAPORE

Storage and Application

WINLUCK must not be covered with dark or black plastic sheet for a prolonged period of time. The temperature buildup underneath can be very high which may damage the top layer of the board. When not in use it is advisable to store the material in its original packing and away from direct ultra violet ray. Under windy conditions, weights of temporary nature should be added on top of the board so as to prevent wind uplift.

OUTSTANDING PROPERTIES

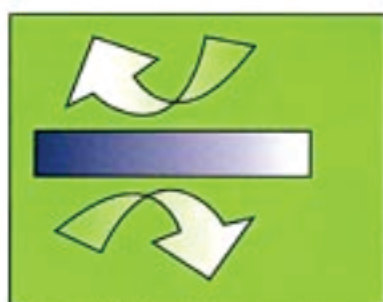

Insulation Enhancement

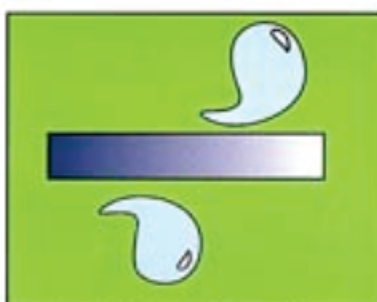

Low Water Absorption



High Compressive Strength



Energy Saving



Easy To Install



Light Weight



KOMIX COMPANY LIMITED
WATERPROOFING & GREEN SYSTEM

662/32 Su Van Hanh, Ward 12, Dist. 10, Ho Chi Minh City
Tel: (+848) 08 3868 9642 Fax: (+848) 08 3868 9642
Website: www.komixvietnam.vn

Our recommendations are made in good faith. Technical datas stated are the result of our tests. Customers are advised to make use of our technical service prior to the installation of our WINLUCK Extruded Polystyrene Board. All statements made should be regarded as a guide and technical information are not binding.